

INSTALLATION OF WINDOW KIT (OPTIONAL)

Please note: the complimentary window kit provided is only suitable for sash windows. It will not work for all window types.

INSTALLATION IN A DOUBLE-HUNG SASH WINDOW

1. Connect the rain guards to the insect guard net.

Insert all three projections on each rain guard into the holes in the insect guard net. Side "A" will now be at the top, as indicated in the diagram.

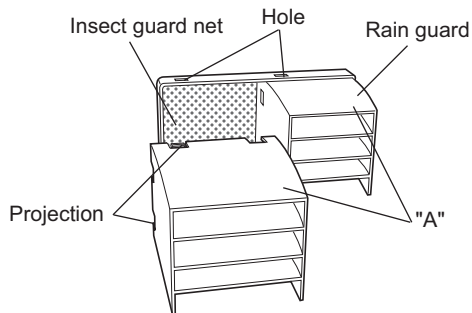

2. Attach the guard combined above to the window panel.

Push the insect guard net firmly to ensure that its four projections fit into the holes in the window panel. Side "A" will now be at the top, as indicated in the diagram.

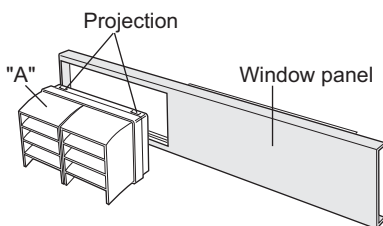

3. Cut the Foam seal B (adhesive type) to the proper length and attach it to the window stool and to the bottom of sash.

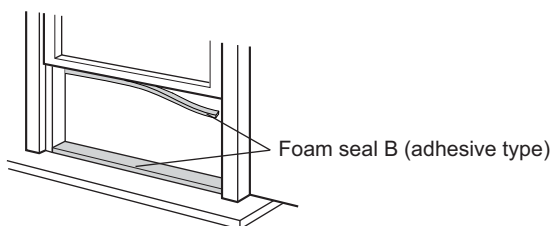

4. Attach the window panel to the window stool.

Make sure that the exhaust cover is attached to the window panel. Inner width of the window: 20.5"(520mm)
Use the window panel.

INSTALLATION OF WINDOW KIT (OPTIONAL)

INSTALLATION IN A DOUBLE-HUNG SASH WINDOW

The window panel cannot be installed in windows less than 20.5" (520mm) wide, as you will not be able to shut the exhaust cover.

- (1) Open the window sash and place the window panel on the window sill.
- (2) Secure the window panel to the window stool with screws.

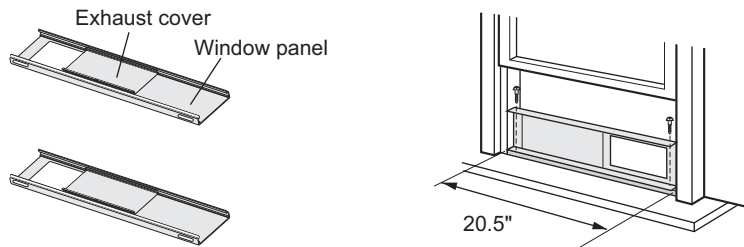

Inner width of the window: 20.5" (520mm) - 37.4" (950mm).

Use the window panel and the adjustment panel.

- (1) Open the window sash and place the window panel on the window sill.
- (2) Slide the adjustment panel to fit the window frame width.
- (3) Secure the window panel to the sill with screws.

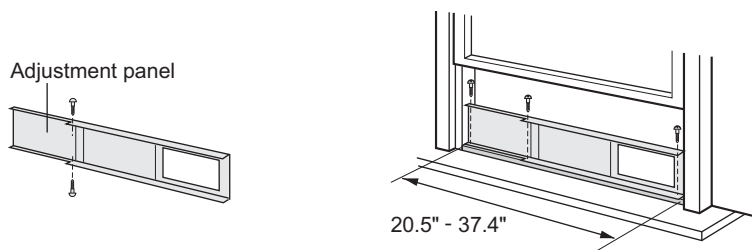

Inner width of the window: 37.4" (950mm) - 56.7" (1440mm)

Use the window panel, the adjustment panel and the extension panel.

- (1) Open the window sash and place the window panel on the window sill.
- (2) Slide the adjustment and extension panels to fit the window frame width.
- (3) Secure the window panel to the window sill with screws.

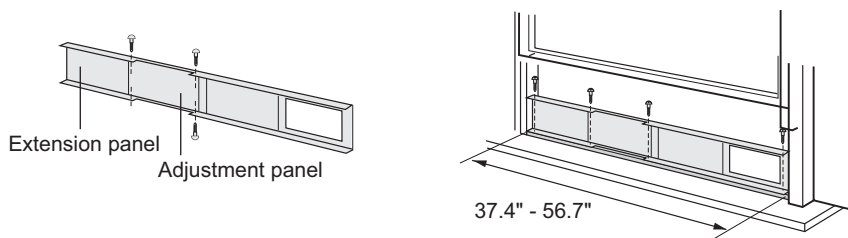

INSTALLATION OF WINDOW KIT (OPTIONAL)

INSTALLATION IN A DOUBLE-HUNG SASH WINDOW

5. Close the window sash securely against the window panel.

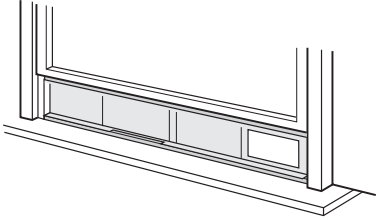

6. Place the foam seal A between the glass and the window to prevent air and insects from getting into the room.

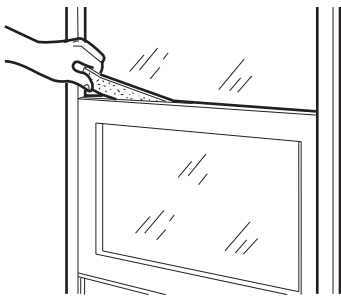

7. Attach the bracket with a screw (recommended).

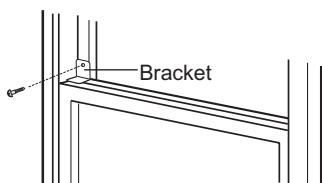

Please lay a tabular material underneath the window panel if you cannot attach the rain guard or the window adapter due to a deep window sill.

INSTALLATION OF WINDOW KIT (OPTIONAL)

INSTALLATION IN A SLIDING SASH WINDOW

1. Connect the rain guards to the insect guard net.
Insert all three projections on each rain guard into the holes in the insect guard net.
Side "A" will now be at the top, as indicated in the diagram.

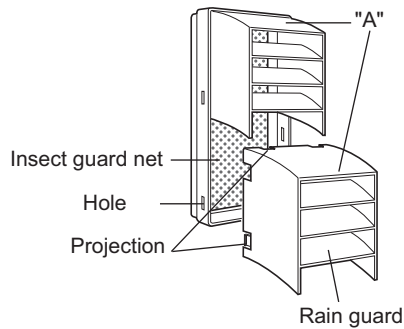

2. Attach the guard combined above to the window panel.
Push the insect guard net firmly to ensure that its four projections fit into the holes in the window panel. Side "A" will now be at the top, as indicated in the diagram, when it is installed in the window.

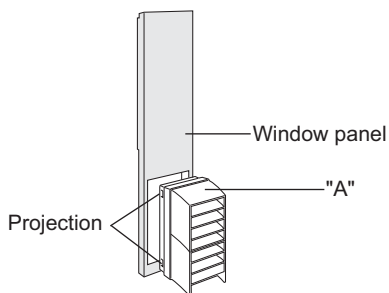

3. Cut the Foam seal B (adhesive type) to the proper length and attach it to the window frame and to the side of sash.

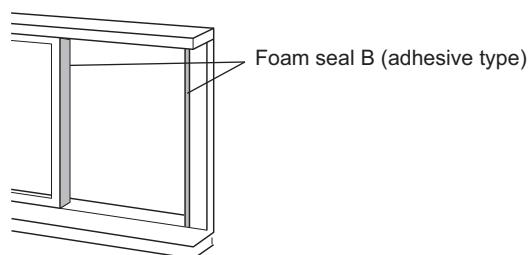

4. Install the window panel into the window frame.
Make sure that the exhaust cover is attached to the window panel.
Inner height of the window:20.5"(520mm)
Use the window panel.

INSTALLATION OF WINDOW KIT (OPTIONAL)

INSTALLATION IN A SLIDING SASH WINDOW

The window panel cannot be installed in windows less than 20.5" (520mm) high, as you will be unable to shut the exhaust cover.

- (1) Open the window sash and place the window panel on the window frame.
- (2) Secure the window panel to the window frame with screws.

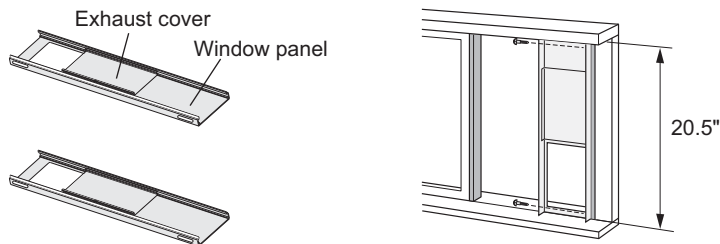

Inner height of the window: 20.5" (520mm) - 37.4" (950mm)

Use the window panel and the adjustment panel.

- (1) Open the window sash and place the window panel on the window frame.
- (2) Slide the adjustment panel to fit the window frame height.
- (3) Secure the window panel to the window frame with screws.

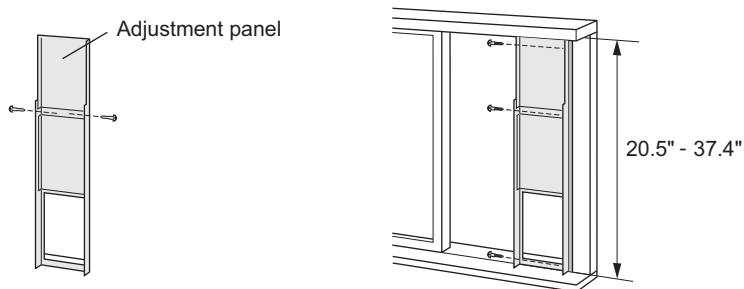

Inner height of the window: 37.4" (950mm) - 56.7" (1440mm)

Use the window panel, the adjustment panel and the extension panel.

- (1) Open the window sash and place the window panel on the window frame.
- (2) Slide the adjustment and extension panels to fit the window frame height.
- (3) Secure the window panel to the window frame with screws.

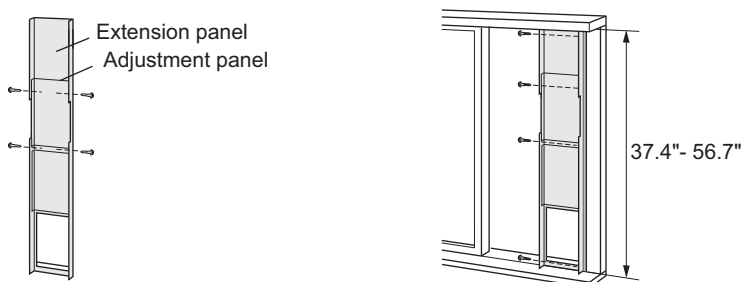

INSTALLATION OF WINDOW KIT (OPTIONAL)

INSTALLATION IN A SLIDING SASH WINDOW

4. Close the window sash securely against the Window panel.

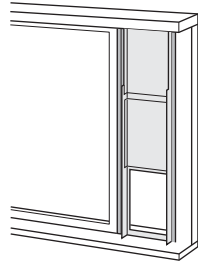

5. Place the foam seal A between the glass and the window to prevent air and insects from getting into the room.

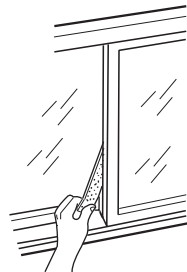

6. Attach the bracket with a screw. (Recommended)

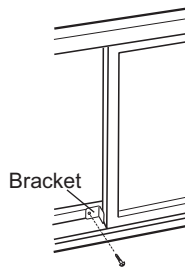

Please lay a tabular material underneath the window panel if you cannot attach the rain guard or the window adapter due to a deep window sill.